

Cremino

Favaretto & Partners

true



Product

Cremino

Designer

Favaretto & Partners

Introduction

Cremino is a collection of side tables designed by Favaretto & Partners for True, inspired by the famous three-layered chocolate from which it takes its name. The layered structure creates a dialogue between materials: a concrete top, textured and minimalist, or a sheet of Murano glass, paying homage to Italian craftsmanship.

Cremino è una collezione di tavolini disegnata da Favaretto & Partners per True, ispirata al celebre cioccolatino a tre strati da cui prende il nome. La struttura stratificata si traduce in un dialogo tra materiali: piano in cemento, materico ed essenziale, oppure in vetro di Murano in lastra, omaggio alla tradizione artigianale italiana.

Cremino



Product

Cremino



Product

Cremino





Product

Cremino





Product

Cremino

Designer

Favaretto & Partners

“A compact gesture of everyday elegance, where proportion, detail, and familiarity come together in a timeless object.”

Favaretto & Partners is an Italian design studio specializing in industrial design and product development for the contract sector. The studio combines creative research with industrial expertise, delivering solutions that integrate functionality, innovation, and production efficiency. Their work is characterized by formal clarity, ergonomic attention, and a strong focus on usability, resulting in products that are both accessible and distinctive.

Cremino





Variants

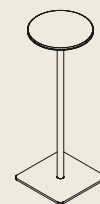

CMT 2570
W25 · D25 · H70



CMT 2960
W29 · D29 · H60

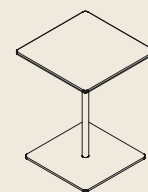

CMT 3850
W38 · D38 · H50

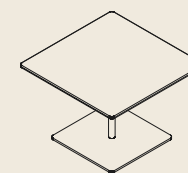

CMT 5035
W50 · D50 · H35

Cremino

Discover the collection ↘

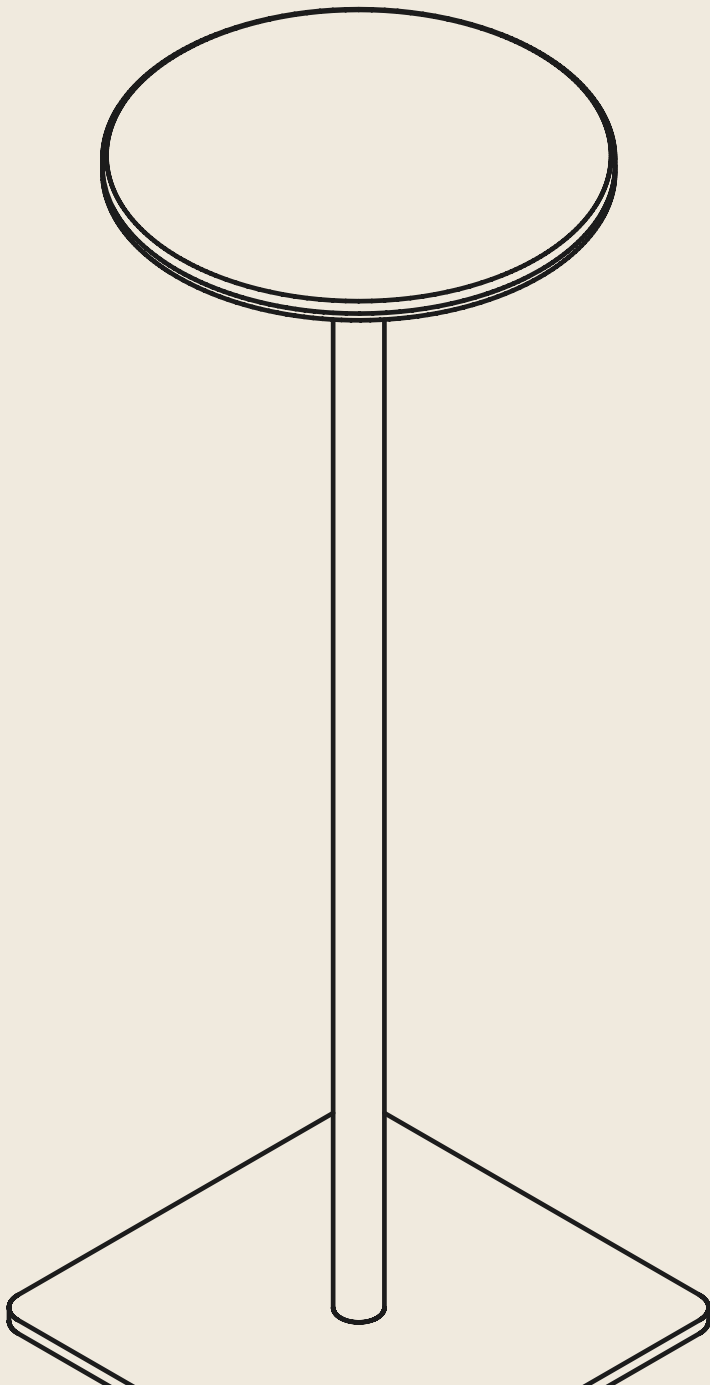

true

True Design s.r.l. a socio unico

Via Leonardo Da Vinci 2 - 35040 Sant'Elena (PD) Italy

Tel. +39 0429 692483 - info@truedesign.it - www.truedesign.it